

**“Colonnade”**

**Round Cast Collared Downpipe**



R  
o  
u  
n  
d  
C  
a  
s  
t  
C  
o  
l  
l  
a  
r  
e  
d  
D  
o  
w  
n  
p  
i  
p  
e



Unit 2, Vitruvius Way  
Meridian Business Park  
Braunstone  
Leicester  
LE19 1WA

Tel: 0116 2894400

Fax: 0116 2894433

E-mail: [sales@arp-ltd.com](mailto:sales@arp-ltd.com)

Web: [www.arp-ltd.com](http://www.arp-ltd.com)

“Colonnade”

## Round Cast Collared Downpipe

R  
o  
u  
n  
d  
C  
a  
s  
t  
C  
o  
l  
l  
a  
r  
e  
d  
D  
o  
w  
n  
p  
i  
p  
e

### **Description:**

Round downpipe formed from extruded 6060 T4 aluminium in conjunction with a LM27 Cast Collar in various sizes (63mm, 76mm & 101mm) & supplied with a complete range of accessories ie offsets, bends, shoes, pipe clips.

### **Installation & Jointing:**

Ensure vertical alignment between drain & gutter outlet.

Collars to be fixed with plastic wall plugs & No.14 x 38mm st.stl screws (dependant on substrate).

Joints to be made up of Ø6mm backing foam caulked into the joint & finished off with sealant to acceptable standard.



Typical section through Collar

# “Colonnade”

## Round Cast Collared Downpipe

### Composition & Manufacture:

‘Colonnade’ downpipes are manufactured from Aluminium alloy 6060 T4 to BS1474: 1972 & the product complies to, or exceeds all relevant standards. Cast Collars are manufactured from LM27 aluminium. Fittings for the downpipes are formed using fabrication methods involving cut, mitre & welding techniques using specially made jig & forming tools.

### Finish:

Mill Finish Aluminium or Polyester Powder Coated to a range of BS or RAL Colours.

### Model Specification:

ARP heavy grade ‘Colonnade’ Cast Eared-Downpipes & fittings to BS 2997 (EN612) using 6060 T4 grade extruded aluminium in accordance with BS 1474: 1974. Profile to be Round\*, size Ø63mm (1.6mm), Ø76mm (1.6mm), Ø101mm (1.6mm).\*

Materials to have factory applied Polyester Powder Coat to all significant surfaces in accordance with BS EN 122026 Matt/Satin/Gloss\* finish, or alternatively plain aluminium Mill Finish. All to be supplied by Aluminium Roofline Products Ltd, Unit 2, Vitruvius Way, Meridian Business Park, Braunstone, Leicester LE19 1WA. Tel 0116 2894400 Fax 0116 2894433.

Joints to be sealed by application of backing foam & Arbosil 1096 Low Modulus Silicone Sealant & fastened by No.14 x 38mm (dependant on substrate) stainless steel screws, in accordance with the manufacturer’s specification & guidelines. Downpipes to be fixed at 2m centres maximum with supplementary brackets at or near fittings.

\* Delete as appropriate



R  
o  
u  
n  
d  
C  
a  
s  
t  
C  
o  
l  
l  
a  
r  
e  
d  
D  
o  
w  
n  
p  
i  
p  
e

# “Colonnade”

## Round Cast Collared Downpipe

### Downpipe Lengths

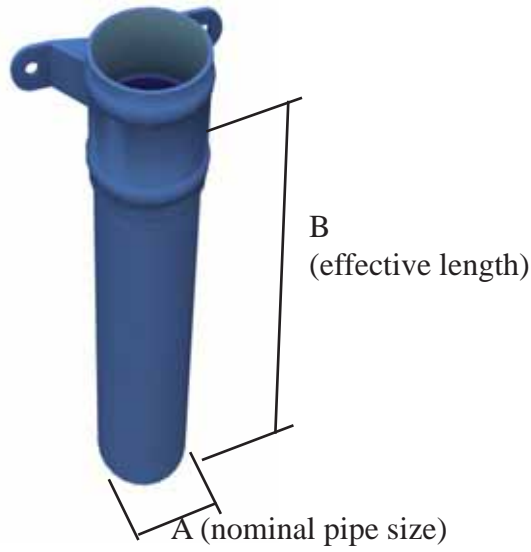

A (mm)	Code B=3.0m	Code B=2.5m	Code B=2.0m	Code B=1.0m	Code B=0.5m
63	2RDP3CE	2RDP2.5CE	2RDP2CE	2RDP1CE	2RDP0.5CE
76	3RDP3CE	3RDP2.5CE	3RDP2CE	3RDP1CE	3RDP0.5CE
101	4RDP3CE	4RDP2.5CE	4RDP2CE	4RDP1CE	4RDP0.5CE

### Bends

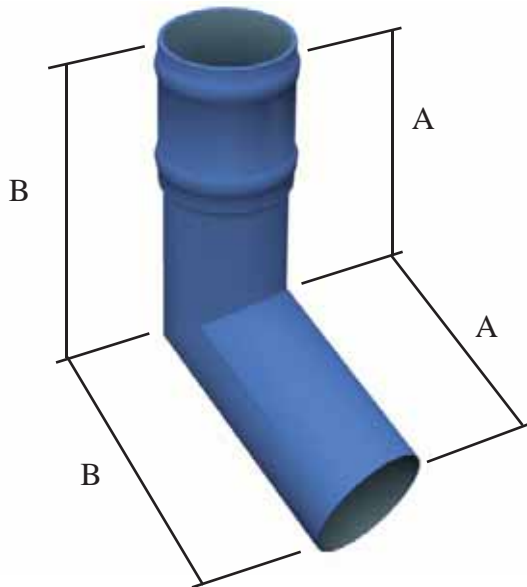

Pipe Size (mm)	Code	A (mm)	B (mm)	Code	A (mm)	B (mm)	Code	A (mm)	B (mm)
		92.5°						135°	
63	2RB92CC	120	180	2RB112CC	120	160	2RB135CC	120	145
76	3RB92CC	120	192	3RB112CC	120	170	3RB135CC	120	150
101	4RB92CC	120	215	4RB112CC	120	185	4RB135CC	120	165

# “Colonnade”

## Round Cast Collared Downpipe

### Y-Branch

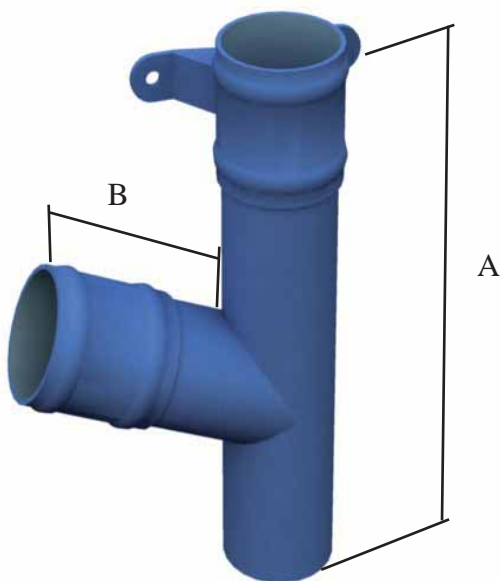

Pipe Size (mm)	Code	A (mm)	B (mm)	Code	A (mm)	B (mm)	Code	A (mm)	B (mm)
	92.5°			112.5°			135°		
63	2RY92CC	300	160	2RY112CC	300	160	2RY135CC	300	160
76	3RY92CC	300	160	3RY112CC	300	160	3RY135CC	300	160
101	4RY92CC	340	160	4RY112CC	340	160	4RY135CC	340	160

### Shoe

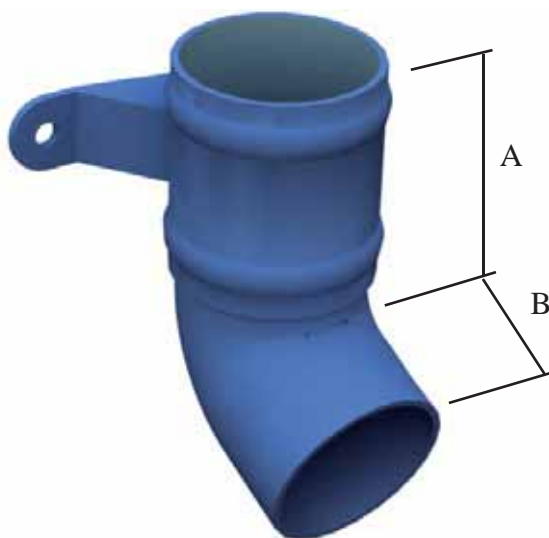

Pipe Size (mm)	Code	A (mm)	B (mm)
63	2RSCE	82	21
76	3RSCE	88	13
101	4RSCE	95	10

R  
o  
u  
n  
d  
C  
a  
s  
t  
C  
o  
l  
l  
a  
r  
e  
d  
D  
o  
w  
n  
p  
i  
p  
e

“Colonnade”

Round Cast Collared Downpipe

**One part Swan-necks**

One part swan-necks are supplied 112.5° as standard. Plinth offsets are supplied 135° as standard. Please specify other requirements.

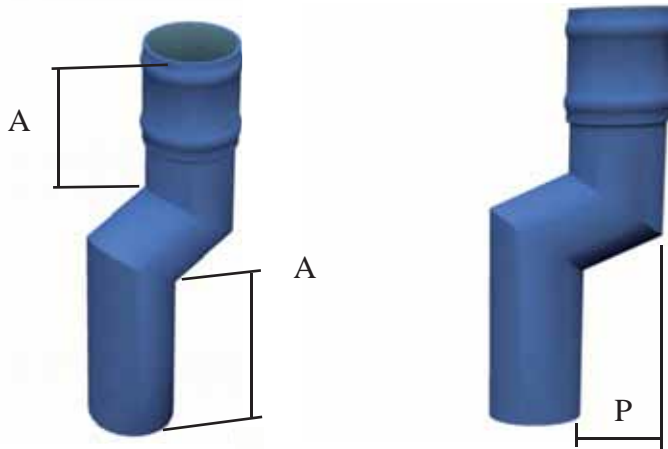

Pipe Size (mm)	A (mm)	Code P=40mm	Code P=63mm	Code P=75mm	Code P=100mm	Code P=150mm
63	120	2RSNC40/1	2RSNC63/1	2RSNC75/1	2RSNC100/1	2RSNC150/1
76	120	3RSNC40/1	3RSNC63/1	3RSNC75/1	3RSNC100/1	3RSNC150/1
101	120	4RSNC40/1	4RSNC63/1	4RSNC75/1	4RSNC100/1	4RSNC150/1

**Two part Swan-necks**

Two part swan-necks are supplied 112.5° as standard. Please specify other requirements

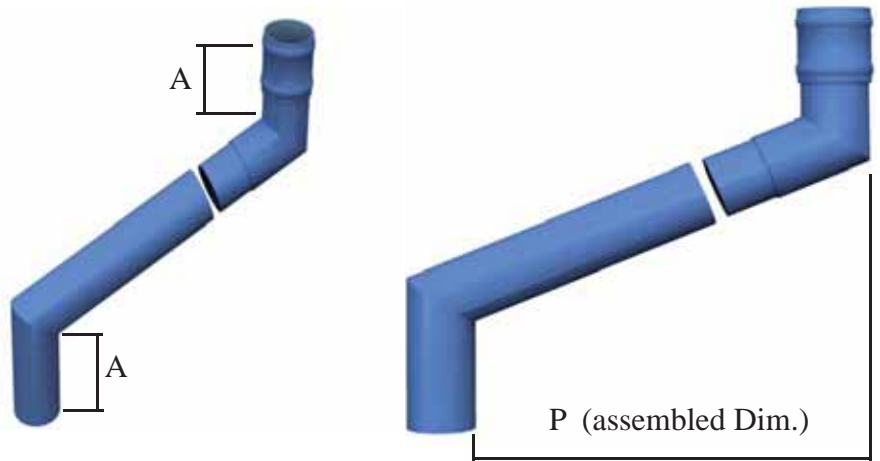

Pipe Size (mm)	A (mm)	Code P=150mm	Code P=300mm	Code P=450mm	Code P=600mm	Code P=750mm
63	120	2RSNC150/2	2RSNC300/2	2RSNC450/2	2RSNC600/2	2RSNC750/2
76	120	3RSNC150/2	3RSNC300/2	3RSNC450/2	3RSNC600/2	3RSNC750/2
101	120	4RSNC150/2	4RSNC300/2	4RSNC450/2	4RSNC600/2	4RSNC750/2

# “Colonnade”

## Round Cast Collared Downpipe

R  
o  
u  
n  
d  
C  
a  
s  
t  
C  
o  
l  
l  
a  
r  
e  
d  
D  
o  
w  
n  
p  
i  
p  
e

### Access Pipe

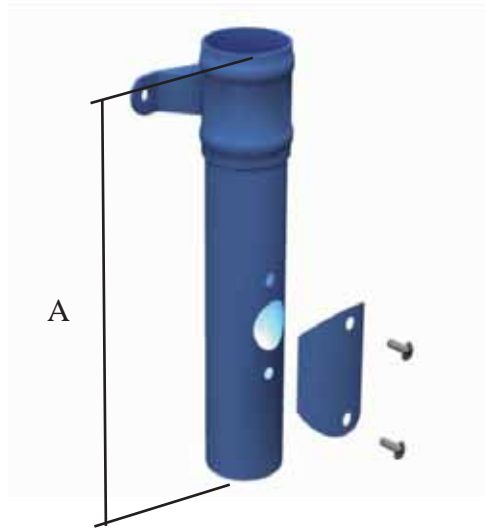

Pipe Size (mm)	Code	A (mm)
63	2RAPPCE	300
76	3RAPPCE	300
101	4RAPPCE	300

### Loose Collars

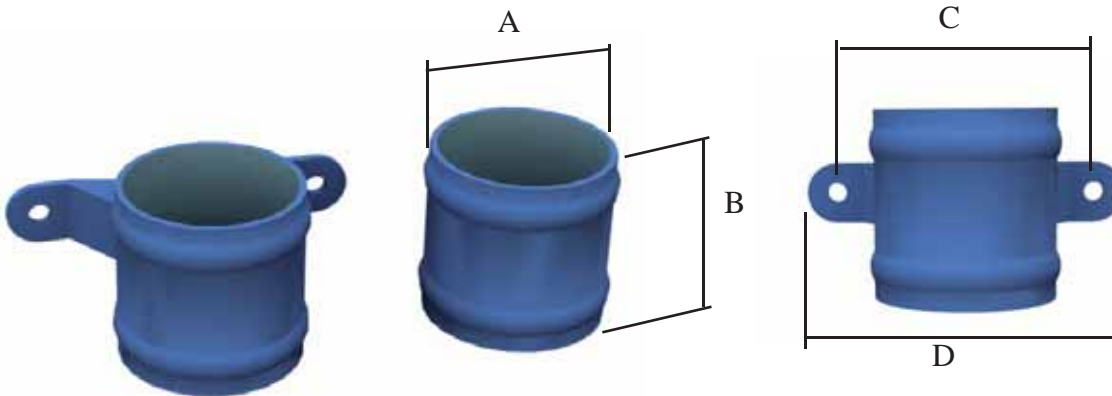

Pipe Size (mm)	Code Eared	Code Plain	A (mm)	B (mm)	C (mm)	D (mm)
63	2RCCE	2RCC	78	76	120	151
76	3RCCE	3RCC	90	86	125	158
101	4RCCE	4RCC	117	101	154	184

# “Colonnade”

## Round Cast Collared Downpipe

### Pipe Clips

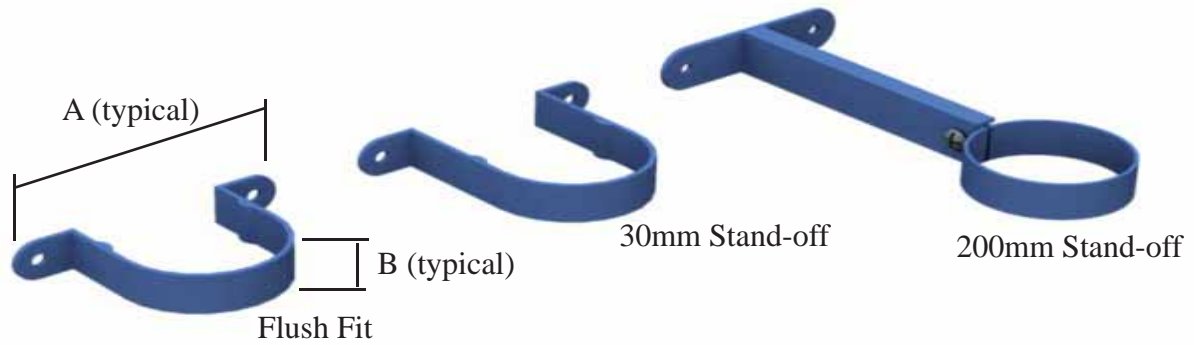

Pipe Size (mm)	A (mm)	B (mm)	Code Flush Fit	Code 30mm s/off	Code 200mm s/off
63	125	25	2RPCFF	2RPC30	2RPCSO200
76	145	25	3RPCFF	3RPC30	3RPCSO200
101	170	25	4RPCFF	4RPC30	4RPCSO200

### Notes:

1. When ordering items such as swan-necks, bends, & Y-Branches combined with eared cast collars it is necessary to specify the orientation of the collar.

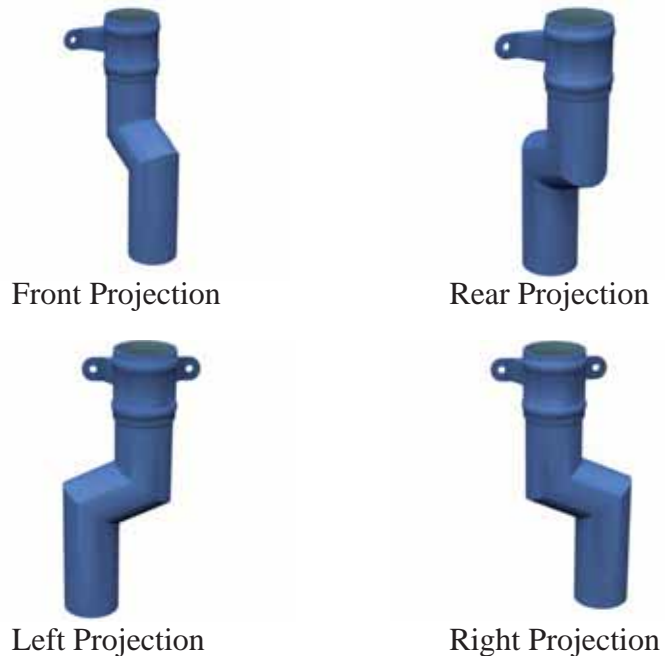



# Handling & Storage

## Handling & Storage:

Gutters/downpipes & fittings, particularly with polyester powder coat finish should be handled with care & should preferably be stored under cover on racks to prevent scratching.

All lengths are supplied in protective polythene wrapping, components suitably packed in boxes.

If painted products are to be stored outside, cover with tarpaulin to guard against water ingress into the protective polythene.

Mill finish items should be stored under cover to avoid uneven oxidization prior to being fitted.

## Safety:

The relevant safety regulations are outlined in the Health & Safety at Work Act 1974 & should be followed.

Refer to CDM regulations (Code of Practice and Design for Health and Safety in Construction 1995)

Handling mill finish or painted aluminium products does not pose any known health hazard, however it is recommended to wear protective gloves whilst handling.

When cutting or welding these products it is advisable to wear eye protection. Avoid ingestion or inhalation of any dust or fumes arising from such operations & use a face mask when necessary.

Precaution needs to be taken to avoid contact with live power lines or cables.

These products generally do not aid combustion & are rated as below.

Mill Finish, non combustible to BS 476 part 4.

Powder coated, 0.1 Fire propagation index BS476 part 6, Class 1 Flame Surface Spread BS 476 part 7.

## Maintenance:

### Post Installation

Gutters & downpipes should be thoroughly checked & water tested for leaks, sealant smudges & any damage that may impair the performance or appearance of the system with the necessary remedial action being taken before the system is handed over.

### Inspection

The gutter should be regularly inspected in terms of fixings, joints, surface damage & build up of leaves or silt. The proximity of trees or climbing vegetation in the immediate vicinity should be noted. Lightning links, if installed should be checked for conductivity.

## Cleaning:

Remove any debris in the gutter to ensure the gutter performs to its original design capacity.

Brushing down a mill finish gutter will be adequate, as an aluminium oxide layer forms over time. This acts as a natural barrier against further corrosion & thus protects the metal.

Polyester powder coated gutters & downpipes should be washed down regularly using non abrasive materials & a warm detergent solution, in marine or other aggressive environments this should be carried out at three monthly intervals. Any breaks in the surface finish should be rubbed down, primed & touched up with a suitable liquid paint.

Guarantees (if required) issued by polyester powder manufacturers or applicators are reliant upon their terms & conditions being met which include maintenance, copies available upon request.

## Health & Safety

### Material Safety Data Sheet - Aluminium Extrusions & Sheet Products

#### Product

Extruded Aluminium sections and/or Aluminium sheet formed to requirements.

#### Composition

The products consist of aluminium which may (or not) be subsequently coated with polyester powder paints or alternative finishes.

#### Health Statement

When subject to the normal purposes for which they are designed, these products do not present health risks or hazards.

By their nature these products may have sharp edges and corners and the use of gloves when handling is recommended. When installing overhead it is advisable to wear head protection.

When cutting or welding these products it is advisable to wear eye protection. Avoid ingestion or inhalation of any dust or fumes arising from such operations and use a suitable face mask when necessary.

Metal is a good conductor of electricity and precautions should be taken to ensure contact with live power lines/cables is avoided.

#### Precautions for Handling & Storage

No special precautions are necessary for normal handling and storage.

#### Procedures in the event of an emergency

There are no special risks associated and the products do not constitute a fire hazard. The products are not generally ignitable.

#### Waste Disposal

Waste products are not hazardous and their disposal should be in accordance with local authority regulations.

## ADSHHEAD RATCLIFFE

### Technical Datasheet Arbosil 1096

Arbosil 1096 is a One-part Low Modulus Neutral Cure Silicone Sealant, which cures on exposure to moisture vapour to form an elastic silicone rubber.

#### Main Application

Recommended for use in many forms of construction including glass wall assemblies, perimeter seals on curtain walling, perimeter sealing of polyester powder coated frames and glazing of windows in swimming pool buildings. *It is not recommended for overpainting and use against natural stone.*

#### Specification Compliances

BS EN ISO 11600 F/G 25LM  
BS 5889 Type A: 1989  
BS 6920 Part 1: 1990 (*Translucent only*)  
German DIN 18545 Class 2 Type E (*Translucent only*)  
German DIN 18540 Class 2 (*All colours except Translucent*)  
US Federal TT-S-00 1543A Class A

#### Application Instructions

##### Joint preparation

The joint surfaces must be clean, dry and free from all contamination. The surfaces should be degreased using the appropriate Arbo Cleaner. Primers may be required on some substrates. It is recommended that Adshead Ratcliffe Technical Services Department should be consulted and advice obtained with regard to the choice of primer for specific purposes.

##### Joint Backing

Where applicable, appropriate joint filler e.g. closed cell polyethylene foam, should be used to provide the correct joint depth.

##### Application

Arbosil 1096 is supplied in cartridges and can be applied into the joint using an Arbo Caulking Gun.

All joint preparation, priming, and sealant application should be carried out in accordance with BS 8000 Part 16, the British Standard for the sealing of joints in buildings using sealants.

#### Joint Size suitability

##### Joint width

Minimum 6mm  
Maximum 25mm (*single application*); 50mm (*Multiple application*)

##### Joint Depth

Minimum 10mm on porous substrates  
Minimum 6mm on non-porous substrates  
Maximum 15mm

##### Width:Depth ratio (*within above min/max restrictions*)

2:1 butt joints  
1:1 lap joints

#### Storage Life

12 months in original unopened package stored in a cool, dry place out of direct sunlight.

#### Health & Safety

Under the Chemical (Hazards Information and Packaging for Supply) Regulations 1994, Arbosil 1096 is labelled 'irritant'. If sealant comes into contact the eyes, flush with copious volumes of cold water and obtain medical attention. For further information consult Product Safety Data Sheet P41A/B.

## ADSHEAD RATCLIFFE

### Technical Datasheet Arbosil 1096

#### Technical Data

<b>Properties</b>	<b>Values</b>
Typical Shore A hardness.....	30
Application temperature.....	+5°C to + 50°C
Service temperature.....	-50°C to +150°C
Skimming time @ 20°C/65%RH.....	5 minutes
Cure rate @ 20°C/65%RH .....	2mm/24 hours
Chemical resistance.....	Resistant to most dilute acids and alkalis; organic solvents may cause the sealant to swell and lose adhesion, but do not directly dissolve the sealant.
UV resistance.....	Very Good
Service life.....	25 years +
Movement accommodation.....	Butt joints ( <i>movement in tension and compression</i> ): 50% ( <i>Not to exceed ± 30% in any one direction</i> ) Lap joints ( <i>movement in shear</i> ): 100% ( <i>Not to exceed ± 70% in any one direction</i> )
Colours.....	White, Black, Grey, Mahogany, Translucent, Anthracite.

#### **Accessories:**

##### **Primers**

Arbo Primer 2650	500ml tin (yield approximately 125 metres per tin)
Arbo Primer 2402	500ml tin (yield approximately 200 metres per tin)
Arbo Primer 2172	500ml tin (yield approximately 200 metres per tin)

##### **Cleaners**

Arbo Cleaner No.13	1Litre tin
<i>(Toluene based – not suitable for use with plastics or delicate finishes)</i>	
Arbo Cleaner No.16	1 Litre tin
<i>(Alcohol based)</i>	

##### **Equipment**

Polyethylene nozzles  
Arbo Caulking Guns

##### **Quantity Estimator**

<i>Joint size</i>	<i>Metres per litre</i>
6 x 6	27.75
9 x 6	18.50
12 x 9	9.25
18 x 10	5.55
25 x 10	4.0

**Packaging:** 25 x 380ml plastic cartridges. Polyethylene nozzles are included in each box.

# Health & Safety

## ARBOSIL 1096

### BIOACCUMULATION

This product is not expected to significantly bioaccumulate.

### DEGRADABILITY

Not degradable.

### ACUTE FISH TOXICITY

Toxicity to fish is improbable.

## 13 DISPOSAL CONSIDERATIONS

### DISPOSAL METHODS

Dispose of waste and residues in accordance with local authority requirements.

## 14 TRANSPORT INFORMATION

### GENERAL

The product is not covered by international regulation on the transport of dangerous goods (IMDG, IATA, ADR/RID).

## 15 REGULATORY INFORMATION

### LABELLING



Irritant

### CONTAINS

METHYL-0,0',0"-BUTAN-2-ONE-TRIOXIMOSILANE

### RISK PHRASES

R43 May cause sensitisation by skin contact.

### SAFETY PHRASES

S24 Avoid contact with skin.  
S37 Wear suitable gloves.  
S60 This material and its container must be disposed of as hazardous waste.

### STATUTORY INSTRUMENTS

Chemicals (Hazard Information and Packaging) Regulations. Control of Substances Hazardous to Health.

### GUIDANCE NOTES

Workplace Exposure Limits EH40. CHIP for everyone HSG(108).

## 16 OTHER INFORMATION

### REVISION COMMENTS

General review

REVISION DATE 120/9/05

REV. NO./REPL. SDS GENERATED 26/02/04

SDS NO. 10171

### RISK PHRASES IN FULL

R36/38 Irritating to eyes and skin.

R43 May cause sensitisation by skin contact.