

ODRAINAGECENTRAL

DRAINAGE, PLUMBING & RAINWATER

Cascade

CAST IRON STYLE RAINWATER AND SOIL SYSTEM



Plumbing & Drainage

For more information please visit www.drainagecentral.co.uk or call us on 03302 230 275

Cascade

CAST IRON STYLE RAINWATER AND SOIL SYSTEM



For more information please visit www.drainagecentral.co.uk or call us on 03302 230 275

Cascade

CAST IRON STYLE RAINWATER AND SOIL SYSTEM



Contents

Cast Iron Style Rainwater and Soil System	3–4
Cast Iron Style Domestic Rainwater Systems	
106mm Prostyle and 65mm Square Downpipe	5–6
112mm Roundstyle and 68mm Round Downpipe	7–8
115mm Deepstyle and 68mm Round Downpipe	9–10
Cast Iron Style High Capacity Rainwater System	
170mm Deepstyle and Downpipes	11–12
Cast Iron Style Hoppers	13–14
Cast Iron Style Soil	15–16
Cast Iron Style Colour Options	17–18
Installation	19–21
Guarantee	22



Cascade

CAST IRON STYLE RAINWATER AND SOIL SYSTEM

Cast Iron has shaped the architectural landscape of our towns and cities since the industrial revolution. Inspired by this heritage, Brett Martin have applied over 50 years experience at the forefront of plastics technology to develop Cascade, a range of gutter and downpipe profiles which provide authentic cast iron styling in plastic.



A unique patented manufacturing process combines with original cast iron detailing on pipework, fittings and hoppers to give the full appearance of cast iron with all the benefits of modern plastic products. This allows the architect to achieve their architectural vision without compromising the requirements of today's fast paced construction contracts on time, money or safety.

- Authentic cast iron architectural detailing
- Extensive choice of styles
- An affordable cast iron alternative
- Quick and easy to install
- Ready to fit
- Lightweight, robust materials
- Fully UV stabilised
- Durable and corrosion resistant
- Compatible with existing rainwater systems



The Cascade range has been sympathetically designed with full consideration to original features, dimensions and detailing to provide heritage style without compromising the architectural integrity of traditionally designed building and renovation projects. In addition to Classic Black, Cascade is available in a choice of heritage colours including Chartwell Green, Anthracite Grey, Oxford Blue, Olive Green, Graphite Grey, Sandstone and Porcelain White.

DOMESTIC SYSTEMS

- 106mm Prostyle Gutter
- 112mm Roundstyle Gutter
- 115mm Deepstyle Gutter
- 65mm Square Downpipe
- 68mm Round Downpipe
- Fittings and Hoppers

HIGH CAPACITY SYSTEM

- 170mm Deepstyle Gutter
- 105mm Round Downpipe
- 100mm x 75mm (4" x 3") Rectangular Downpipe
- Fittings and Hoppers

SOIL SYSTEM

- 110mm Soil Pipe
- Soil Stack Shroud
- Access Fittings and Adaptors



Plumbing & Drainage

For more information please visit www.drainagecentral.co.uk or call us on 03302 230 275

Cascade

CAST IRON STYLE RAINWATER AND SOIL SYSTEM

Domestic Rainwater System - 106mm Prostyle.



The sleek lines and modern styling of the Prostyle Cast Iron Style Rainwater System provide a more contemporary finish with a quality Cast Iron look and feel. Offering a modern twist on heritage styling, the Prostyle system is ideally suited to traditionally styled new build projects.

- Authentic detailing and finish on downpipe, guttering, hoppers and fittings
- Fully compatible with the Cast Iron Style Soil System
- Incorporates 65mm Square Downpipe
- Choice of Ogee, Bath, Gothic and motiffed hopper designs
- Available in eight colour options



For more information please visit www.drainagecentral.co.uk or call us on 03302 230 275



Cast Iron Style Gutter Capacities

		Gutter Flow Capacity Litres per second		Maximum Roof Area m ²	
		Level	1:600	Level	1:600
106mm Prostyle	Outlet at one end	2.05	2.55	97	121
	Outlet at centre	4.1	5.1	195	242

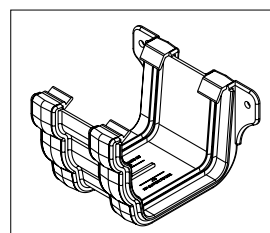
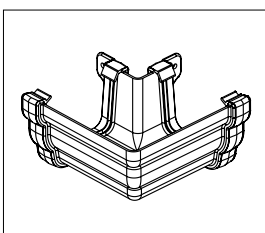
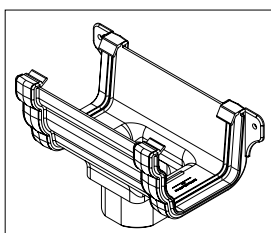
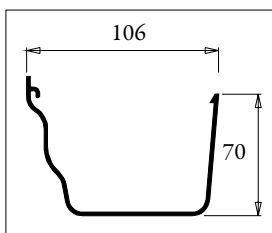

Cascade

CAST IRON STYLE RAINWATER AND SOIL SYSTEM

Domestic Rainwater System - 112mm Roundstyle.



The Roundstyle Cast Iron Style Rainwater System is synonymous with traditional cast iron styling and blends perfectly with the architectural detailing on heritage buildings, being virtually indistinguishable from original Cast Iron systems. The authentic styling of the Roundstyle system is suitable for both period styled new build and renovation projects alike.

- Authentic detailing and finish on guttering, downpipe, hoppers and fittings
- Fully compatible with the Cast Iron Style Soil System and traditional Cast Iron
- Incorporates 68mm Round Downpipe
- Choice of Ogee, Bath, Gothic and motiffed hopper designs
- Available in eight colour options



For more information please visit www.drainagecentral.co.uk or call us on 03302 230 275



Cast Iron Style Gutter Capacities

	Gutter Flow Capacity Litres per second		Maximum Roof Area m ²	
	Level	1:600	Level	1:600
112mm Outlet at one end	1.00	1.3	48	62
Roundstyle Outlet at centre	1.82	2.43	87	116

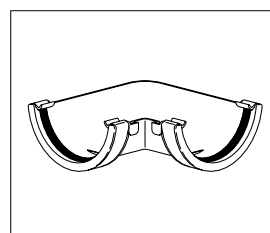
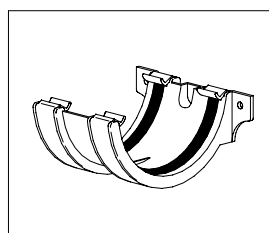
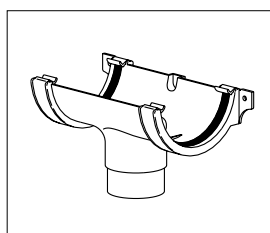
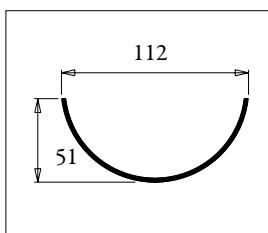

Domestic Rainwater System

- 115mm Deepstyle.



Combining period Cast Iron detailing and styling, Deepstyle is a higher capacity semi elliptical rainwater system, providing greater drainage efficiency on larger roof areas.

- Authentic detailing and finish on downpipe, guttering, hoppers and fittings
- Fully compatible with the Cast Iron Style Soil System
- Incorporates 68mm Round Downpipe
- Choice of Ogee, Bath, Gothic and motiffed hopper designs
- Available in eight colour options





Cast Iron Style Gutter Capacities

		Gutter Flow Capacity Litres per second		Maximum Roof Area m ²	
		Level	1:600	Level	1:600
115mm Deepstyle	Outlet at one end	1.88	2.30	90	110
	Outlet at centre	3.75	4.58	180	220

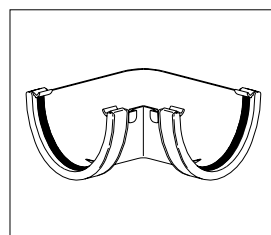
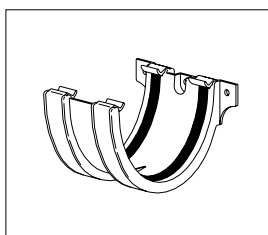
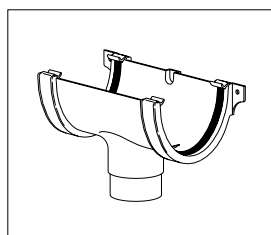
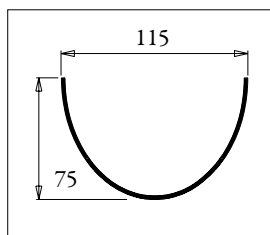

Cascade

CAST IRON STYLE RAINWATER AND SOIL SYSTEM

High Capacity Rainwater System - 170mm Deepstyle.



The High Capacity Cast Iron Style Rainwater System is ideally suited to traditionally styled buildings with larger roof areas. Period style detailing combined with very high levels of roof drainage ensure that this system can be used on a wide variety of large heritage style buildings. Featuring 105mm Round Downpipe and 100 x 75mm Rectangular Downpipe, this system has been purposefully designed with close attention to detail. This authentic looking system can be used as a direct refurbishment replacement of Cast Iron in commercial buildings, churches, Georgian and Victorian shop frontage and larger period dwellings. Double seals on outlets, unions and angles guarantee optimum performance of this large, robust Cast Iron Style gutter system.

- Authentic detailing and finish on downpipe, guttering and fittings
- Fully compatible with the Cast Iron Style Soil System and traditional Cast Iron
- Double seals on outlet, unions and angles
- Incorporates 105mm Round Downpipe and 100 x 75mm Rectangular Downpipe
- Gutter fittings feature factory fitted CLIP & SEAL technology for ease of installation and completely watertight joints
- Available in eight colour options



For more information please visit www.drainagecentral.co.uk or call us on 03302 230 275



Cast Iron Style Gutter Capacities

		Gutter Flow Capacity Litres per second		Maximum Roof Area m ²	
		1:350	1:600	1:350	1:600
170mm	Outlet at one end	5.77	5.12	275	244
Deepstyle	Outlet at centre	11.54	10.24	550	488

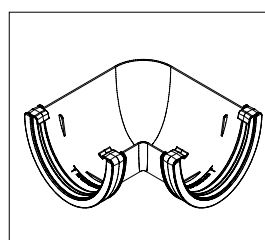
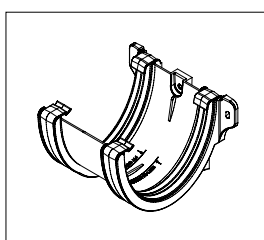
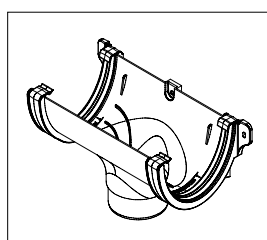
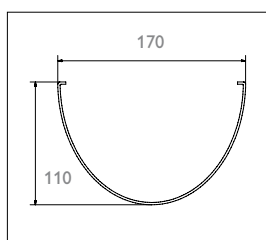

Cascade

CAST IRON STYLE RAINWATER AND SOIL SYSTEM

Hoppers



Brett Martin's extensive range of authentic hopper styles and designs provides the opportunity for the designer and home owner to individualise their rainwater system. The hopper designs include traditional Ogee, Bath and Gothic hoppers and a choice of period motifs including Tudor Rose, Fleur de Lys, Lion and Gargoyles.



Ogee



Gothic



Bath



Hopper Motifs



i. Fleur de lys



ii. Lion



iii. Tudor Rose



iv. Leaf



v. Gargoyle



vi. Date



vii. Four Leaf Square



Plumbing & Drainage

For more information please visit www.drainagecentral.co.uk or call us on 03302 230 275

Cascade

CAST IRON STYLE RAINWATER AND SOIL SYSTEM

Cast Iron Style Soil System



To complement Cast Iron Style Domestic and High Capacity Rainwater Systems, the Cascade range includes a comprehensive Cast Iron Soil System with a realistic cast iron finish. Designed to incorporate traditional cast iron detailing with all the benefits of a plastic system, the Cast Iron Soil System completes the range providing a cost effective alternative to Cast Iron in renovation or new build projects.

- 110mm Soil Pipe
- Soil Stack Shroud
- Access Fittings and Adaptors



Push Fit

Fully sealed, Cast Iron Style Soil is a Push-fit Soil System which offers fast installation and maximum durability. Due to the system's range of seals and adapters, it is fully compatible with other systems. The provision of long lasting rubber seals, retained by strong snap caps, gives the convenience of Push-fit installation plus prolonged reliability. At ground level the Cast Iron Soil System fully integrates with Brett Martin's Underground Drainage Systems.

- Authentic detailing and finish on guttering, downpipe, shroud, clips and fittings
- Fully compatible with the Cast Iron Style rainwater systems and traditional Cast Iron
- Convenient push fit installation
- Fully sealed, reliable system
- Integrates with Brett Martin Underground Drainage Systems
- Available in eight colour options



Cascade

CAST IRON STYLE RAINWATER AND SOIL SYSTEM

Colours



Cascade Cast Iron Style Rainwater and Soil System is available in a choice of heritage colours to cater for the subtle nuances of local architectural vernacular. In addition to Classic Black, there is a choice of Anthracite Grey, Chartwell Green, Oxford Blue, Olive Green, Graphite Grey, Sandstone and Porcelain White which reflect the trend for priming and painting traditional systems. The complete colour range delivers the traditional appearance of Cast Iron with the convenience of modern plastic materials.



Anthracite Grey

Chartwell Green

For more information please visit www.drainagecentral.co.uk or call us on 03302 230 275